

INSTALLATION MANUAL FOR KIT 29.2180.01.0565 TRANSIT/CUSTOM OEM TAKE-OFF (TANK)

Please read these instructions from start to finish before commencing with the installation process.

If in doubt, contact Eberspächer UK Technical Support for assistance.

The kit is supplied with 6 metres of fuel line, pre-assembled to the in-line Raymond connector (figure 1). The fuel line and protective conduit (also supplied) will need to be cut to length according to the heater installation, as follows:

Airtronic S2 (D2):	5 metres (maximum)
Airtronic M2 (D4):	2 metres (maximum)
Hydronic HS3:	2 metres (maximum)

1. Lower the fuel tank to access the auxiliary fuel port (figure 2).
2. Cut the tip off the fuel port (see figure 3) and deburr. This will open the fuel port accordingly.
3. The take-off kit comes pre-assembled with the correct length of fuel line protruding from the in-line connector assembly (shown in Figure 4). This length is determined by the make and model of the vehicle for which the kit was designed. If you are using the kit for anything other than a Ford Transit/Connect, please ensure that you check for the correct length based on the vehicle manufacturer guidelines. Length can be adjusted by loosening the clip (see figure 4) however care must be taken to ensure that the fuel line does not touch the bottom of the tank and the clip must be re-tightened accordingly to 0.5Nm (-0/+0.2) once the correct length is established. **If in doubt, contact Eberspächer UK Technical Support for assistance.**

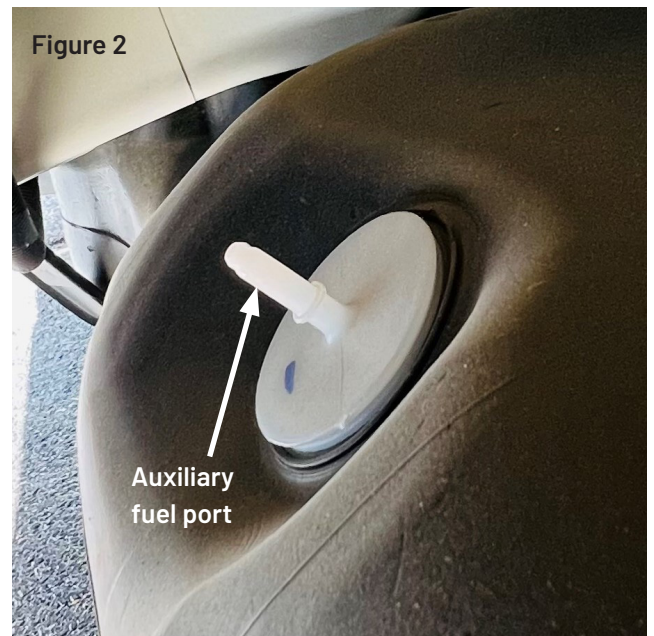

Figure 3

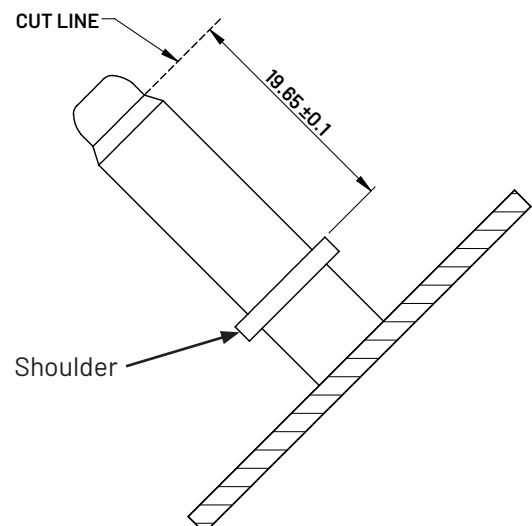
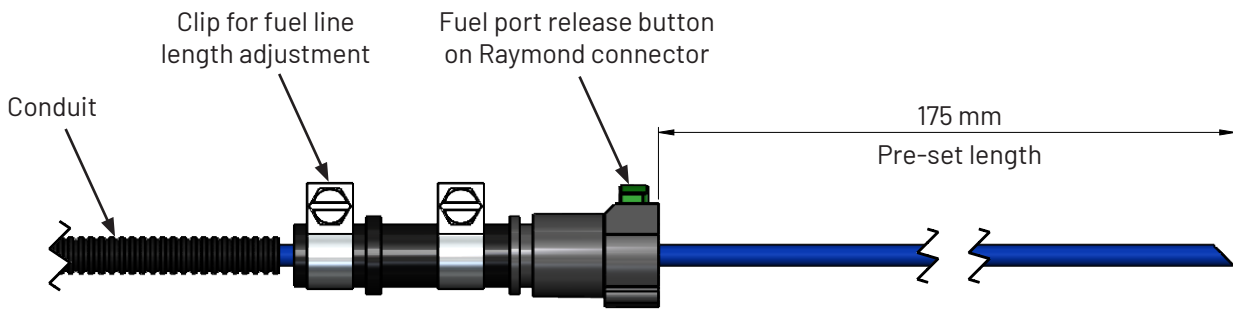
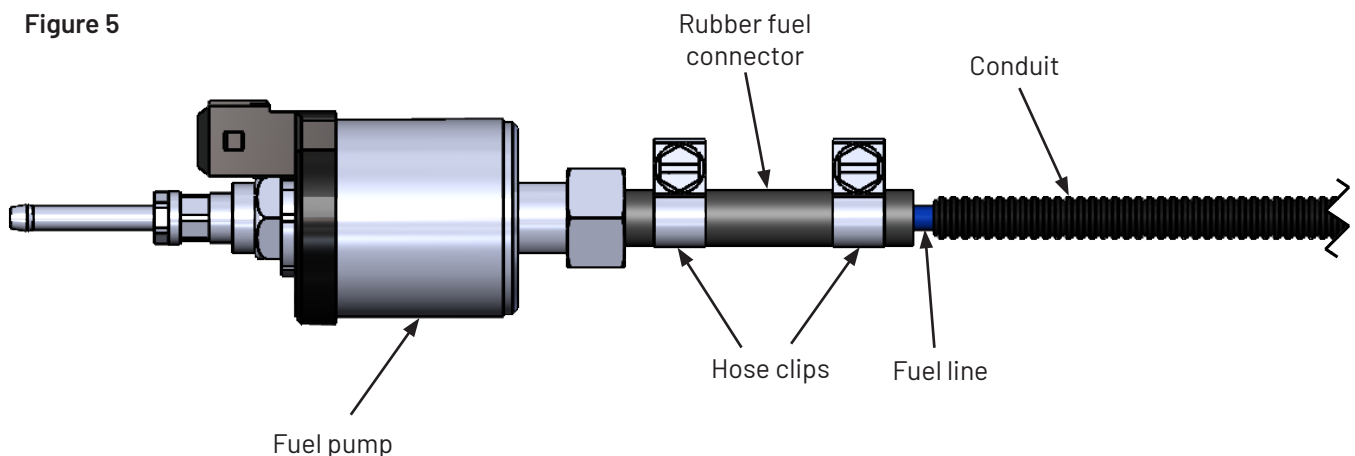

Figure 4



4. Insert the fuel line into the open auxiliary fuel port. Ensure that the fuel line is straight when fitting, or that any curvature is angled downwards, towards the bottom of the tank. Push the in-line connector fully onto the fuel port until it engages (clicks) with the shoulder near the base of the port (shown in figure 3). When fitted correctly, the in-line connector can only be released by pressing and holding the green button at the base of the connector (see figure 4).
5. Cut the fuel line and conduit to the desired length (according to heater installation). Ensure there are no kinks in the fuel line and that the conduit fully protects the fuel line from potential damage / fretting.
6. Attach the fuel line to the fuel metering pump using the rubber fuel connector provided (see figure 5). Ensure both the pump spigot and the fuel line are fully inserted and butted together. Recommended torque setting for hose clips is 1.0Nm (-0/+0.2). Ensure there are no kinks in the fuel line and that the conduit fully protects the fuel line from potential damage / fretting.

Figure 5



If in doubt, contact Eberspächer UK Technical Support for assistance.

Revision	Author	Checked	Approved	Date
A	C CROCKER			