

Part Number: 801 10 001 AIRTRONIC D2 / D4 / D5 heaters only. 1 hour run time

Part Number: 801 10 003 AIRTRONIC D2 / D4 / D5 heaters only.

INSTALLING THE DIGITAL MODULATOR

- Cut out the template and position it.
- Drill the three 7.5mm dia. holes.
- Route cable loom of Modulator through cable entry hole.
- Fit the Digital Modulator by gently pushing into mounting holes.

CONNECTING THE DIGITAL MODULATOR

Part Number 801 10 001 / 801 10 003

Connect the cables to the 6-way housing supplied with the Digital Modulator as follows:

RED CABLE	Connect to pin 1	BAT +
YELLOW CABLE	Connect to pin 2	ON +
BROWN CABLE **	Connect to pin 3	** ECU -
GREY/RED CABLE	Connect to pin 4	MOD Ω
GREY CABLE *	Connect to pin 5	* Ω
BLUE/WHITE CABLE	Connect to pin 6	DIAG

* The grey cable is an optional connection for external heater air sensing, see heater technical description manual.

** The brown Digital Modulator cable must be connected to the heater brown/white (ECU-) cable.

MOUNTING POSITION

Ensure the Modulator is not installed in a position which could effect the sensor reading i.e. In direct sunlight, draughts, etc.

6-WAY JUNIOR POWER TIMER TAB HOUSING

Tab terminals 2.8mm

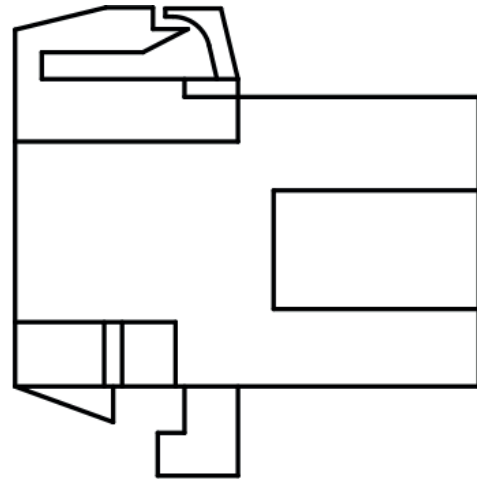

Side View

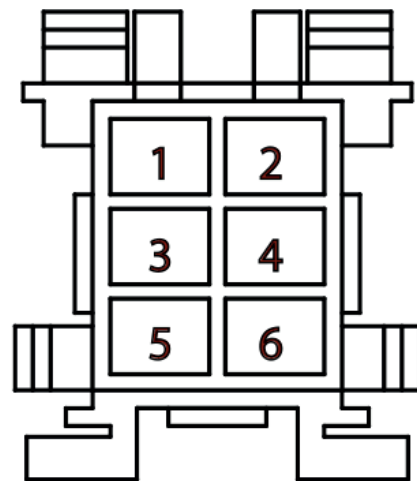

Cable Entry View

FULL SIZE DRILLING TEMPLATE

Up to 8mm thickness (Over 8mm thickness use **optional** mounting plate part number 190489).

Viewed from the front of the Modulator.

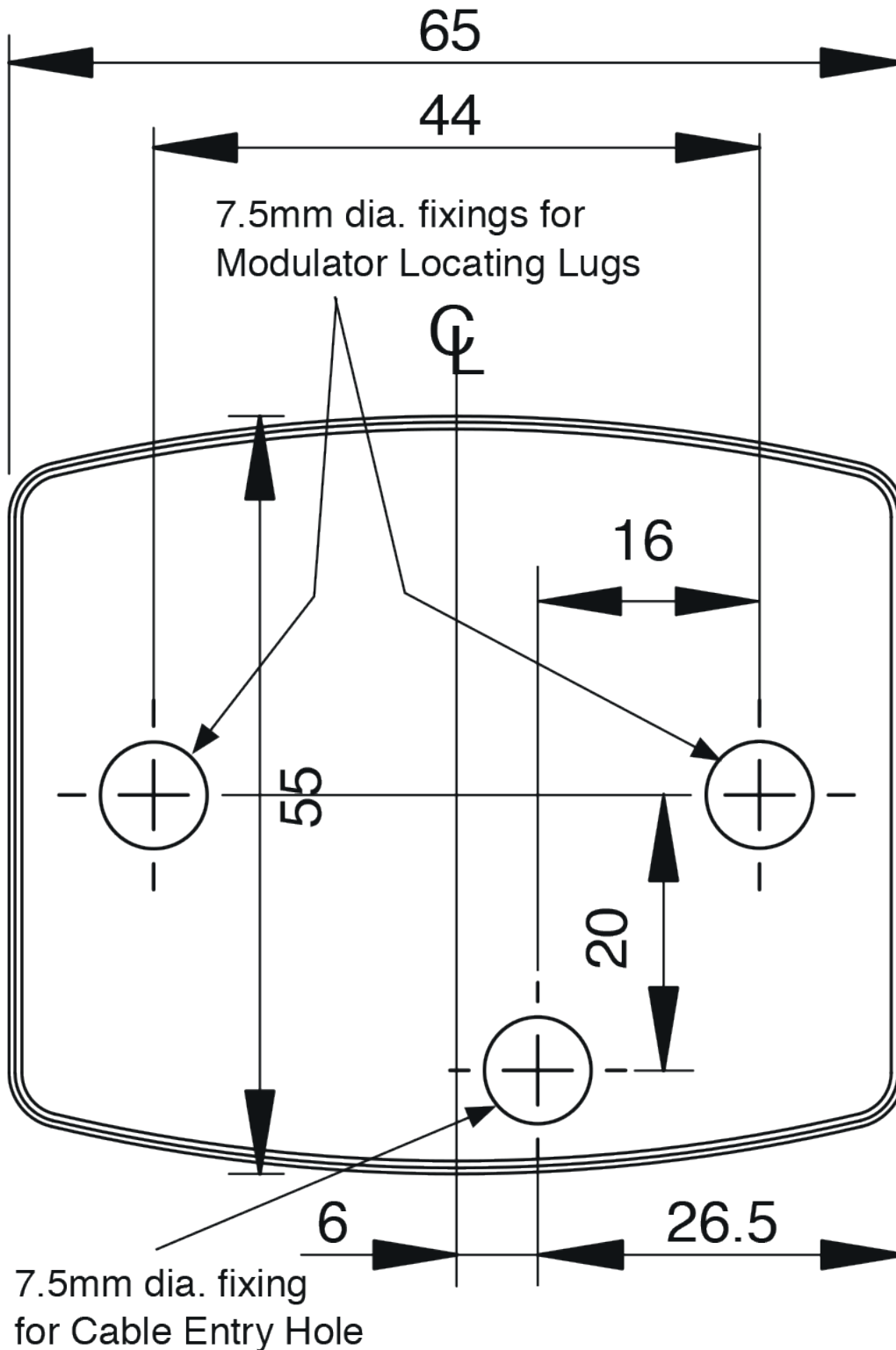

INSTALLATION INSTRUCTIONS

801 Series Digital Modulator

Part Number: 801 10 001 AIRTRONIC D2 / D4 / D5 heaters only + housing, 1 hour run time.

Part Number: 801 10 003 AIRTRONIC D2 / D4 / D5 heaters only + housing.

INSTALLING THE DIGITAL MODULATOR

- Cut out the template and position it.
- Drill two 7.5mm dia. holes.
- Drill 26mm dia. hole for cable / connector housing.
- Route cable loom of Modulator through cable entry hole.
- Fit the Digital Modulator by gently pushing into mounting holes.

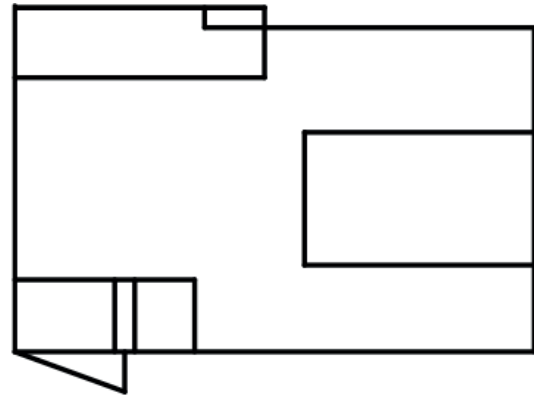

Side View

MOUNTING POSITION

Ensure the Modulator is not installed in a position which could effect the sensor reading i.e. In direct sunlight, draughts, etc.

6-WAY JUNIOR POWER TIMER TAB HOUSING

Tab terminals 2.8mm

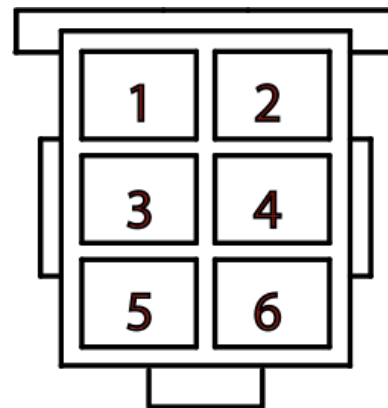

Cable Entry View

FULL SIZE DRILLING TEMPLATE

Up to 8mm thickness (Over 8mm thickness use **optional** mounting plate part number 190489).

Viewed from the front of the Modulator.

